

Prepared for
Australian Rail Track Corporation Ltd
ABN: 75 081 455 754



Environment Report

Appendices

Inland Rail - Beveridge to Albury

Appendix A

Site names, locations
and design options

Appendix A Site names, locations and design options

Enhancement sites

Table 56 Summary of enhancement sites (from Project Description)

Site name
Wandong
Hamilton Street, Broadford
Short Street, Broadford
Marchbanks Road, Broadford
Tallarook
Seymour-Avenel Road, Seymour
Hume Highway, Seymour
Euroa
Benalla
Glenrowan
Wangaratta Precinct
Barnawartha North

Broadford-Wandong Road, Wandong (Wandong)



Hamilton Street, Broadford



Short Street, Broadford

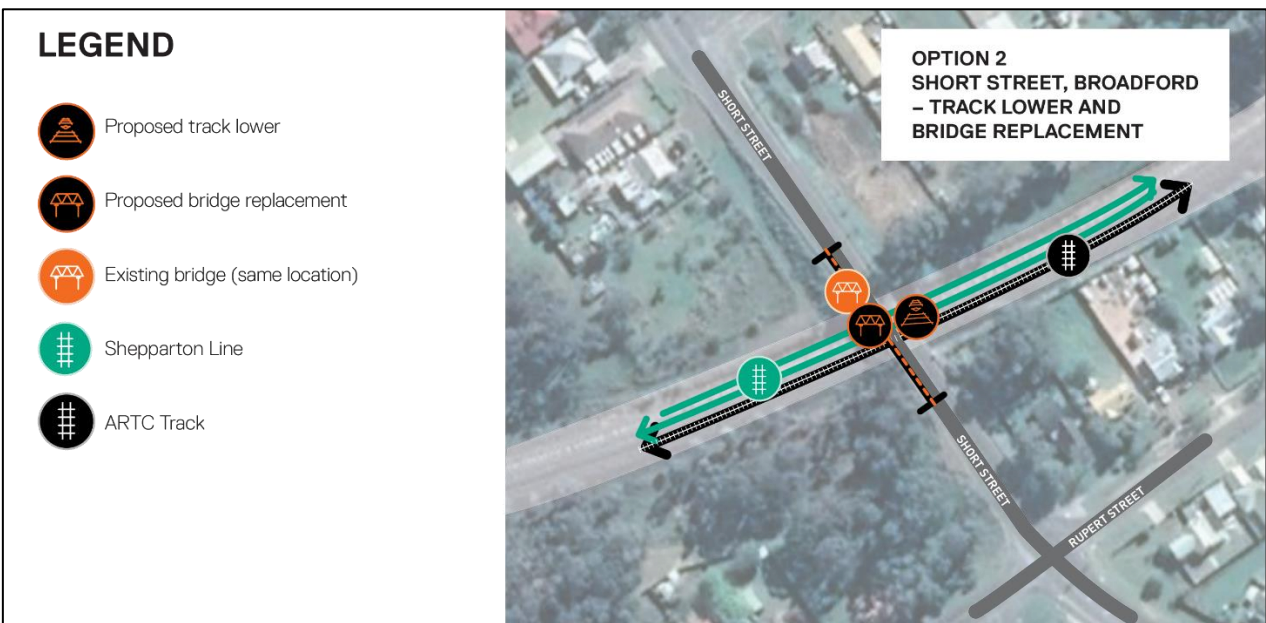
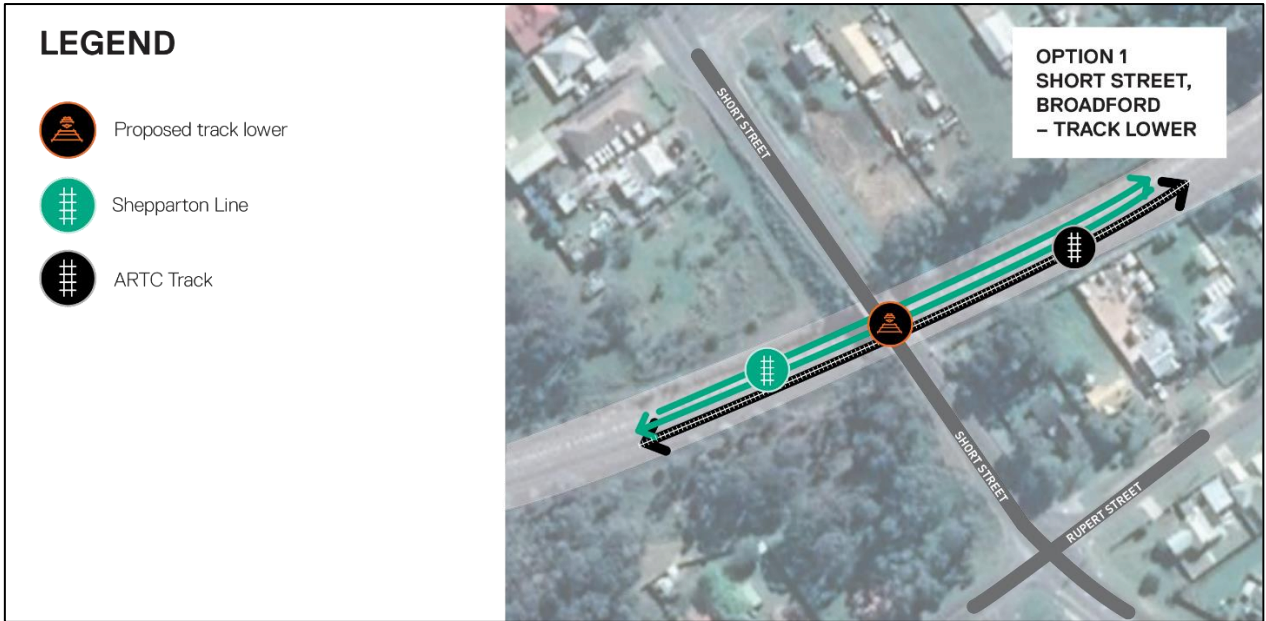

Marchbanks Road, Broadford



Hume Highway, Tallarook (Tallarook)

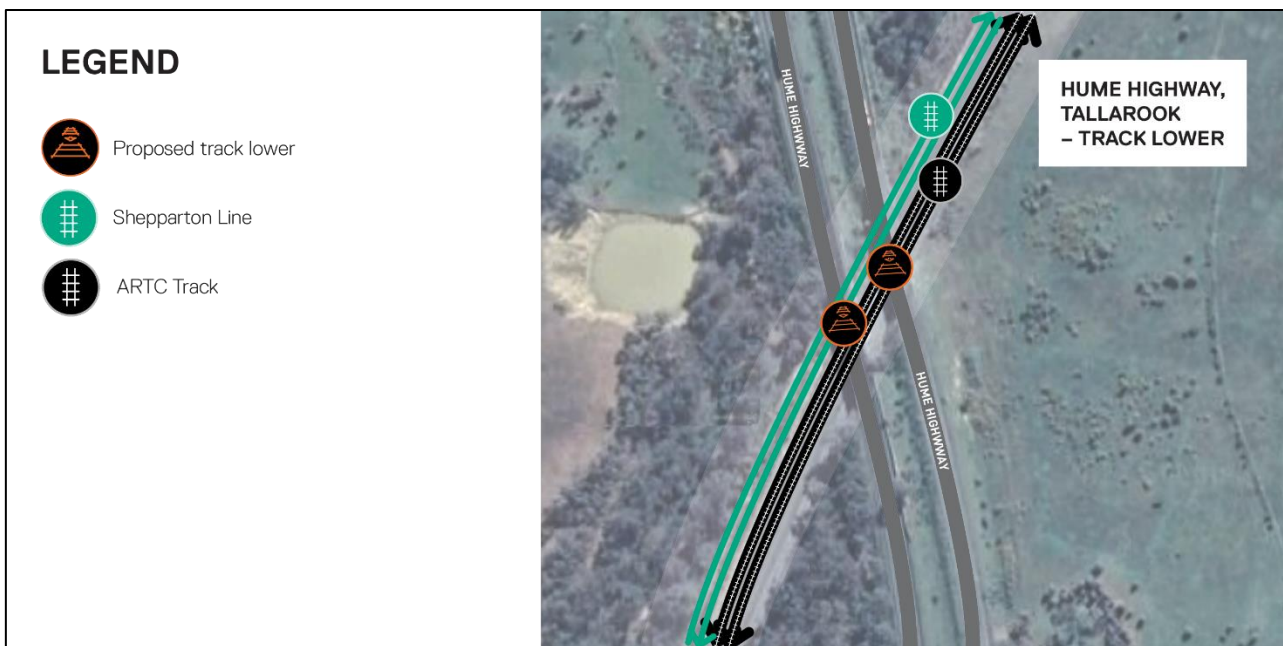

Seymour-Avenel Road, Seymour



Hume Highway, Seymour

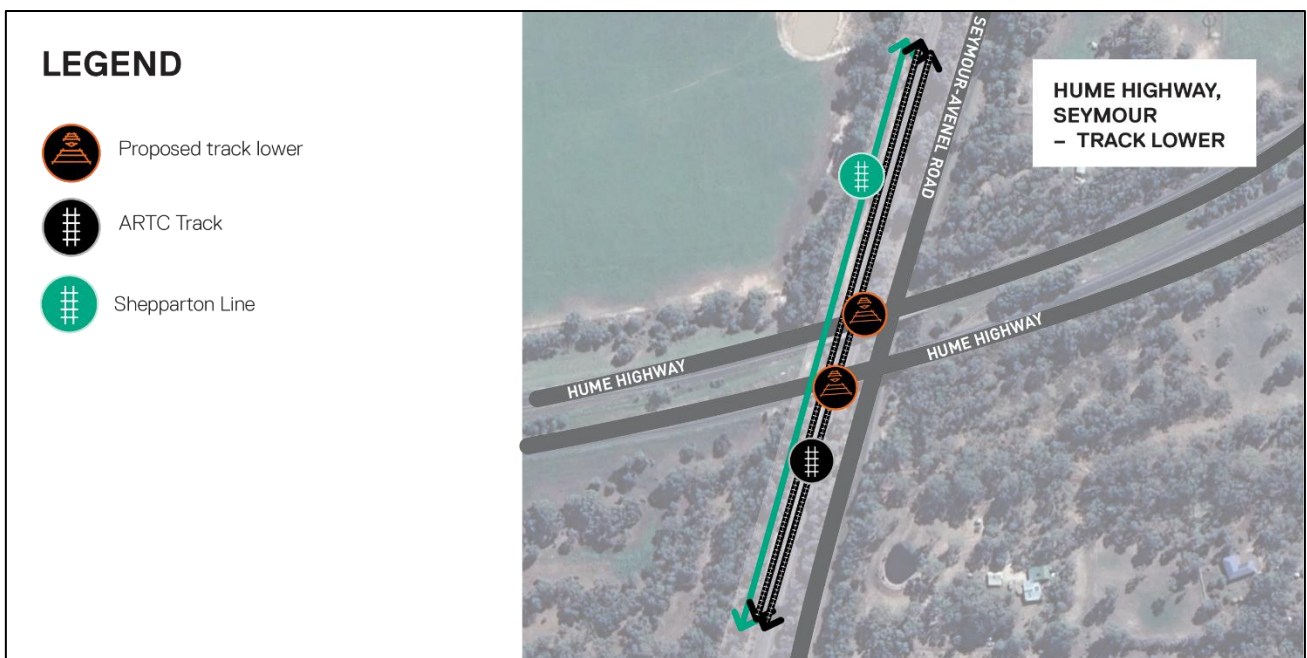

Euroa Station precinct (Euroa)

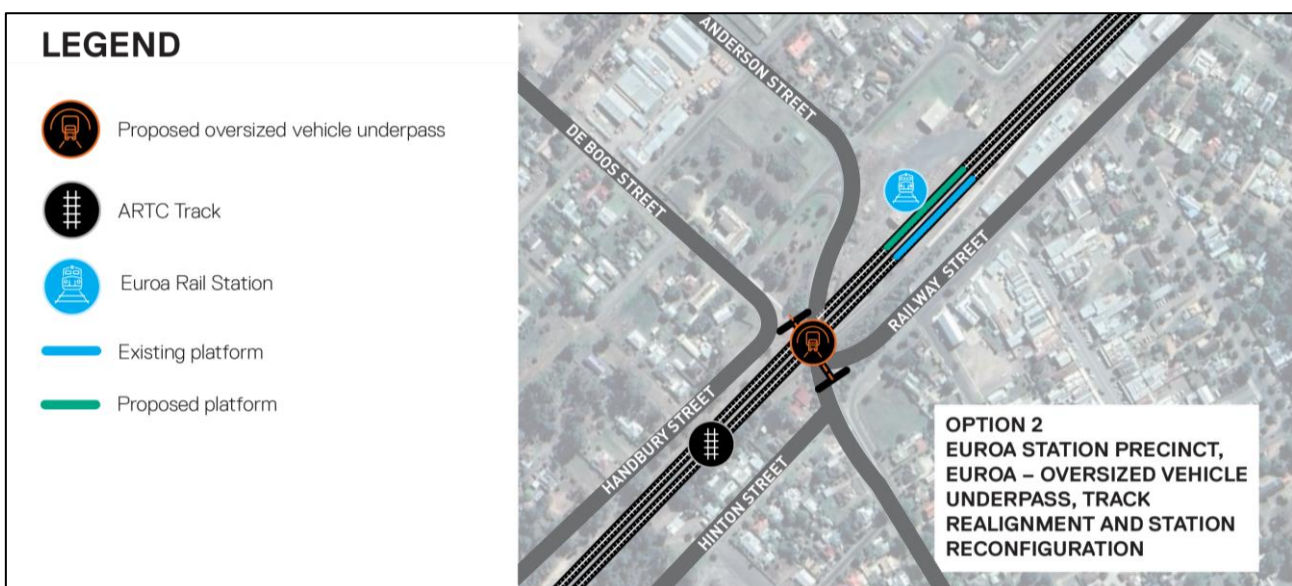
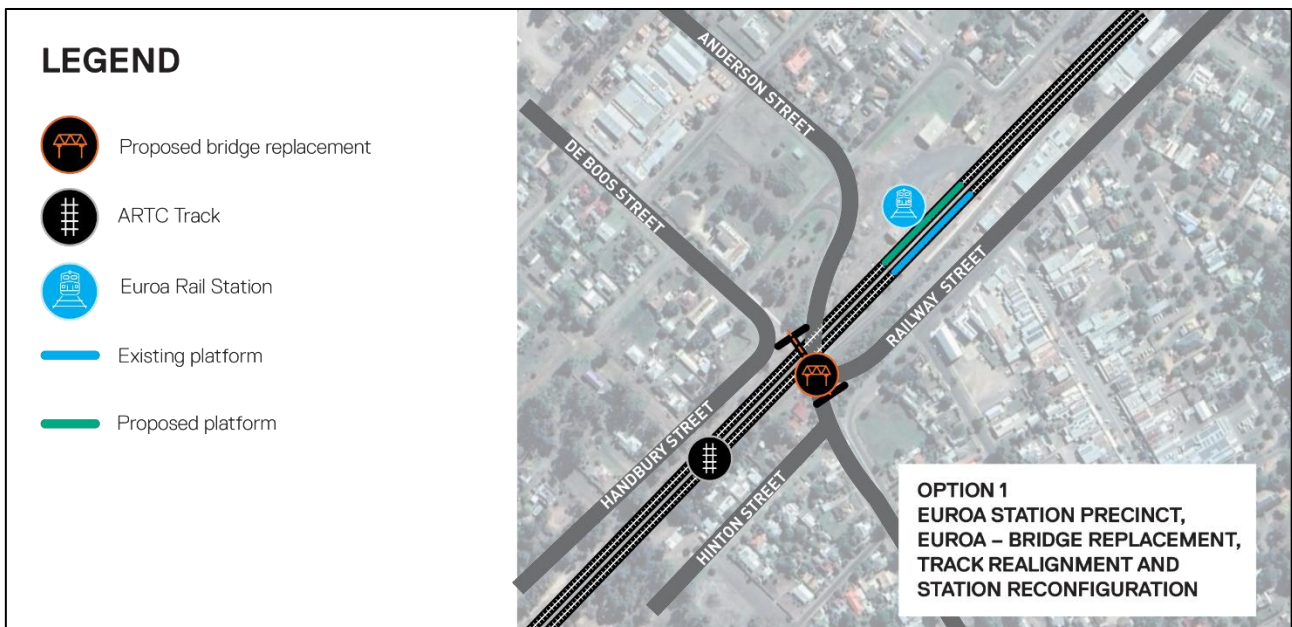
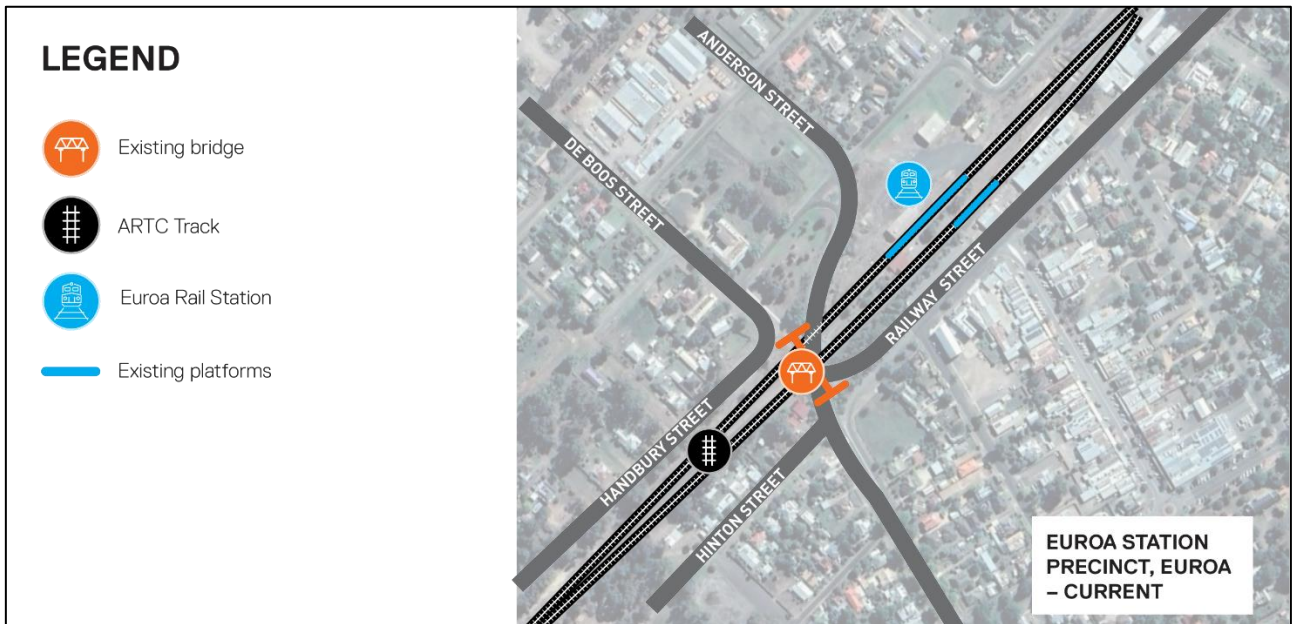

Benalla Station Precinct (Benalla)



Beaconsfield Parade, Glenrowan (Glenrowan)



Wangaratta Precinct

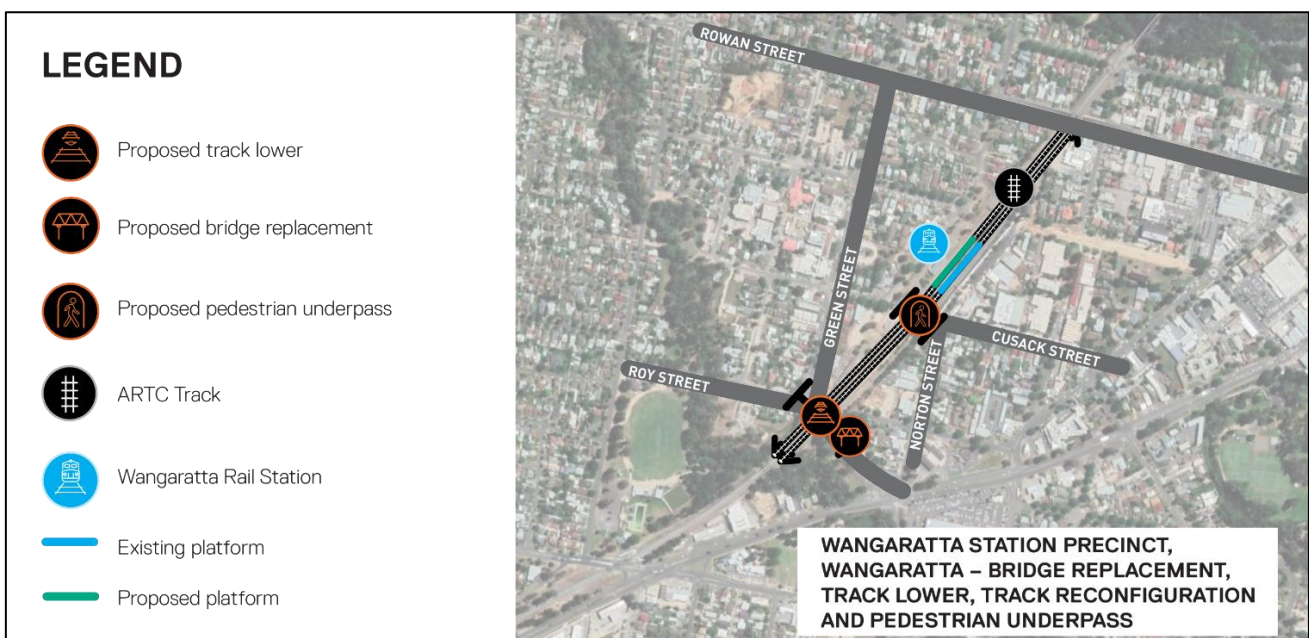

Murray Valley Highway, Barnawartha North (Barnawartha North)

LEGEND



Proposed track lower



ARTC Track

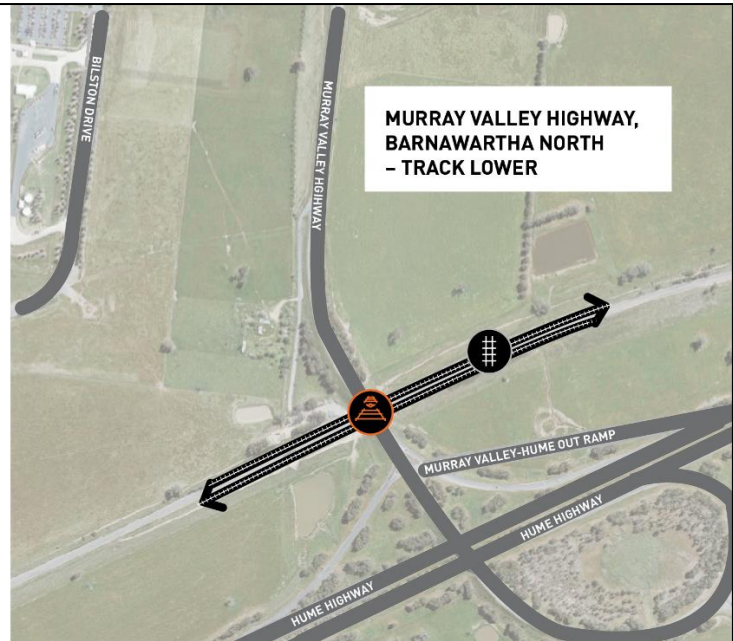

Track slews

Table 57 Summary of track slews (from Project Description)

No.	Location	Chainage (approx. km)
1	Wallan Loop	47.3 – 48.8
2	Tallarook Loop	88.8 – 89.5
3	Seymour Goulburn River	95.4 – 96.9
4	Seymour Station	98.8 – 99.5
5	Seymour – Mangalore	100.1 – 109.6

Signal gantries

Table 58 Summary of signal gantries (from Project Description)

No.	Location	Chainage (approx. km)
1	Beveridge	43.8
2	Beveridge	46.543
3	Wallan	47.389
4	Wallan	48.960
5	Wallan	49.108
6	Kilmore East	66.167
7	Kilmore East	66.221
8	Kilmore East	69.790
9	Broadford	73.660
10	Broadford	75.641
11	Broadford	76.819
12	Broadford	79.956
13	Tallarook	83.055
14	Tallarook	86.247
15	Tallarook	93.509
16	Tallarook	95.644
17	Seymour	97.305
18	Seymour	99.120
19	Seymour	102.210
20	Seymour	103.165
21	Wangaratta	233.780

Overhead powerlines**Table 59 Summary of overhead powerline investigation areas (from spatial data)**

Site ID	Location	Chainage (approx. km)
1001	Mitchell	47.26
1002	Mitchell	48.4
1003	Mitchell	50.65
1004	Mitchell	53.36
1006	Mitchell	54.27
1007	Mitchell	55.11
1008	Mitchell	64.22
1009	Mitchell	65.31
1010	Mitchell	67.04
1011	Mitchell	70.26
1012	Mitchell	71.62
1013	Mitchell	73.43
1014	Mitchell	75.31
1015	Mitchell	75.67
N10	Mitchell	76.57
1016	Mitchell	76.87
1017	Mitchell	76.9
N9	Mitchell	77.88
1018	Mitchell	78.62
1019	Mitchell	80.01
1020	Mitchell	87.4
1021	Mitchell	89.79
1022	Mitchell	95.18
1023	Mitchell	98.21
1024	Mitchell	98.31
1025	Mitchell	98.62
1026	Mitchell	98.64
1027	Mitchell	Not provided
1029	Mitchell	99.035
1030	Mitchell	99.08
1031	Mitchell	99.14
1033	Mitchell	99.31
1034	Mitchell	99.58
1035	Mitchell	100.03

Site ID	Location	Chainage (approx. km)
1036	Strathbogie	108.65
1037	Strathbogie	114.95
1038	Strathbogie	116.15
1039	Strathbogie	122.14
1040	Strathbogie	127.46
1041	Strathbogie	128.95
1042	Strathbogie	133.6
1043	Strathbogie	134.87
1045	Strathbogie	136.525
1046	Strathbogie	136.555
1047	Strathbogie	143
1048	Strathbogie	150.85
1049	Strathbogie	151.04
1050	Strathbogie	151.08
1051	Strathbogie	151.76
1052	Strathbogie	158.96
1053	Strathbogie	169.45
1054	Strathbogie	169.45
1055	Strathbogie	169.75
1056	Strathbogie	170.19
1057	Strathbogie	171.5
1058	Strathbogie	177.25
1203	Strathbogie	114-93-115.622
1059	Benalla	183.13
1060	Benalla	188.65
1061	Benalla	191.44
1062	Benalla	191.9
1063	Benalla	193.3
1064	Benalla	193.3
1065	Benalla	Not provided
1204	Benalla	195.06
1067	Benalla	196.84
1068	Benalla	197.57
1069	Benalla	198.07
1070	Benalla	201.28
1071	Benalla	204.76

Site ID	Location	Chainage (approx. km)
1072	Benalla	208.4
1075	Benalla	210.97
1076	Benalla	213.94
1077	Benalla	213.94
1078	Wangaratta	215.58
1080	Wangaratta	215.58
1081	Wangaratta	219.95
1082	Wangaratta	219.95
1083	Wangaratta	220.72
1084	Wangaratta	220.72
1085	Wangaratta	221.7
1086	Wangaratta	221.97
1087	Wangaratta	222.26
1088	Wangaratta	223.52
1089	Wangaratta	225.64
1205	Wangaratta	229.084
1090	Wangaratta	230.4
1091	Wangaratta	231.17
1092	Wangaratta	232.51
1093	Wangaratta	232.095
2	Wangaratta	233.52
1094	Wangaratta	233.7
1095	Wangaratta	233.78
1097	Wangaratta	234.1
1098	Wangaratta	234.15
1099	Wangaratta	234.6
1100	Wangaratta	236.29
1101	Wangaratta	237.29
1102	Wangaratta	238.52
1103	Wangaratta	239.3
1104	Wangaratta	239.89
1105	Wangaratta	240.78
1206	Wangaratta	244.93
1106	Wangaratta	256.97
1107	Wangaratta	258.33
1108	Wangaratta	259.21

Site ID	Location	Chainage (approx. km)
1109	Indigo	262.03
1110	Indigo	267.19
1111	Indigo	269.25
1112	Indigo	270.91
1113	Indigo	272.22
1115	Indigo	271.38
1116	Indigo	272.22
1117	Indigo	273.69
1118	Indigo	279.2
1119	Indigo	279.52
1120	Indigo	280.3
1121	Indigo	280.91
1207	Wodonga	283
1122	Wodonga	284.93
1123	Wodonga	286.54
1124	Wodonga	290.91
1125	Wodonga	301