

# A2I | June 2025 Monthly Update

## Junee & Junee to Illabo

Martinus has been engaged to undertake construction on the Albury to Illabo section of the Inland Rail project in New South Wales.

The work will occur during our standard construction hours **7am to 6pm Monday to Saturday**.

In the event that work is required outside these construction hours, impacted neighbours will be notified in advance.

### Work being done

Martinus will continue to undertake work in Junee and Junee to Illabo, weather and ground conditions permitting.

### Overview of works

#### Junee

- Setting up construction boundary. Temporary flagging will be erected to delineate our future site compound facilities.
- Service and geotechnical investigation, including non-destructive digging (NDD) around the Kemp Street precinct.
- Geotechnical investigation within the rail corridor and adjacent road reserves.
- Line marking on Seignior Street

#### Junee to Illabo

- Regular deliveries will be accepted to the Illabo site compound located at the GrainCorp silo.
- Cadastral surveys will continue within the Illabo area.
- Dynamic Cone Penetrometer (DCP) testing will occur within the corridor
- Culvert and drainage installation
- Material deliveries
- Service and geotechnical investigation, including non-destructive digging (NDD)
- Signalling work

### Temporary traffic changes near you

- During construction, vehicle movements will be to and from site, as well as on site.
- Traffic controllers will be in place to safely direct traffic around Kemp Street, Junee.
- Temporary speed changes along the Olympic Hwy near Illabo.

### What can I expect?

Unfortunately, some construction activities are inherently noisy which cannot be avoided. Properties near these areas can expect to hear:

- Heavy vehicle movements, geotechnical investigations and pavement coring.
- excavation activity involving the removal of existing surfaces such as rock, soil and pavement
- loading, unloading and moving equipment and construction materials

### Machinery Used

Equipment used for work includes but is not limited to hand-held tools, non-destructive digging truck, drilling rig, water carts, survey equipment, power washer, tipper truck, skid steer, traffic management equipment, heavy and light vehicles.

### How we're managing impacts

- Traffic controls will be in place where required.
- Water carts will be on-site to wet down areas to assist in managing dust.
- Works programmed to best minimise noise impacts.
- Works will be monitored to ensure compliance with Project Conditions of Approval
- Use of non-tonal reversing alarms on all equipment and turning off equipment when not in use.
- Instructing workers to keep noise to a minimum and being respectful of our neighbours.

For any concerns or enquiries phone **1800 732 761** or email [inlandrailnsw@inlandrail.com.au](mailto:inlandrailnsw@inlandrail.com.au)

Information about Inland Rail is available at <https://inlandrail.com.au/>

**Thank you for your patience and cooperation while we carry out these works.**

☎ 1800 732 761    @ inlandrailnsw@inlandrail.com.au

✉ GPO Box 14, Sydney NSW 2000



Please call our free translation and interpreter service on **131 450** (24 hours a day) if English is your second language and you need help reading this document

## Location of work

### Junee

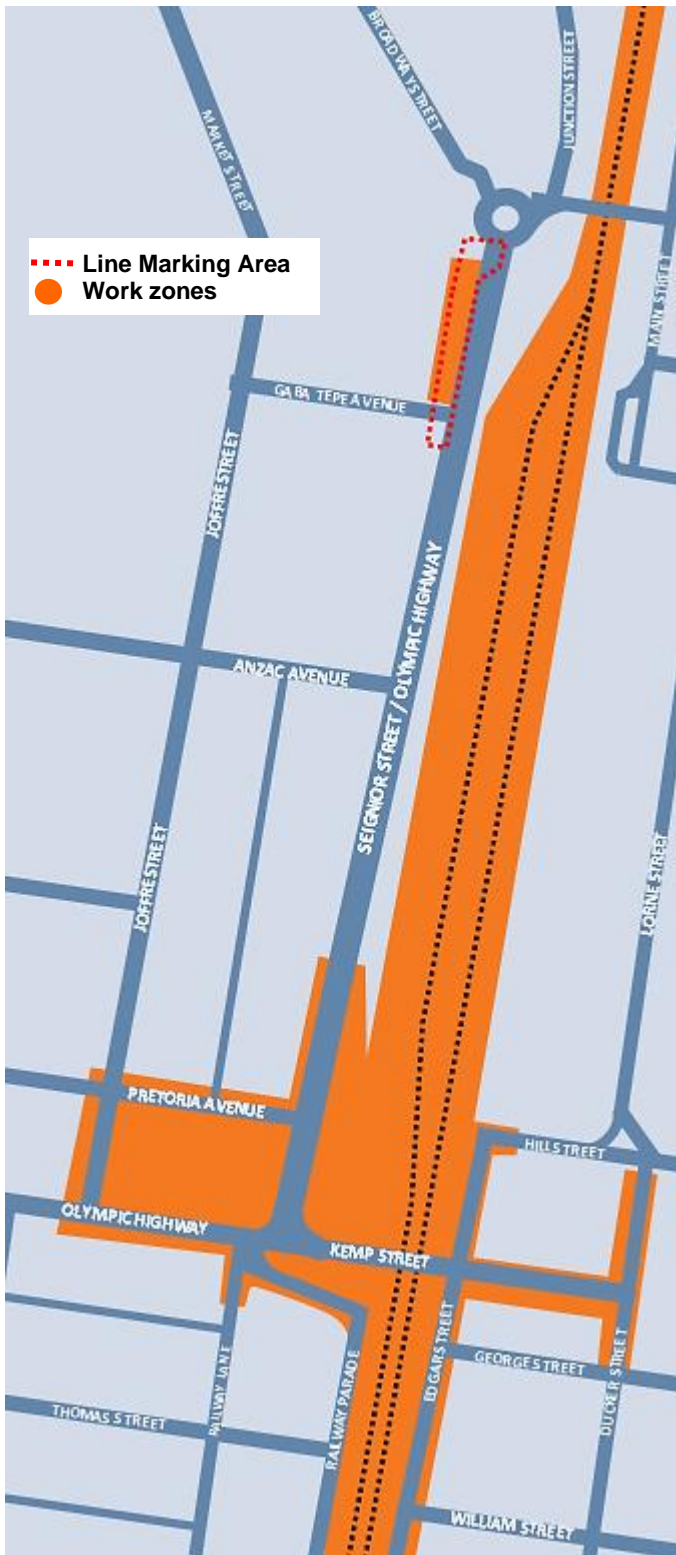

### Illabo



### Marinna

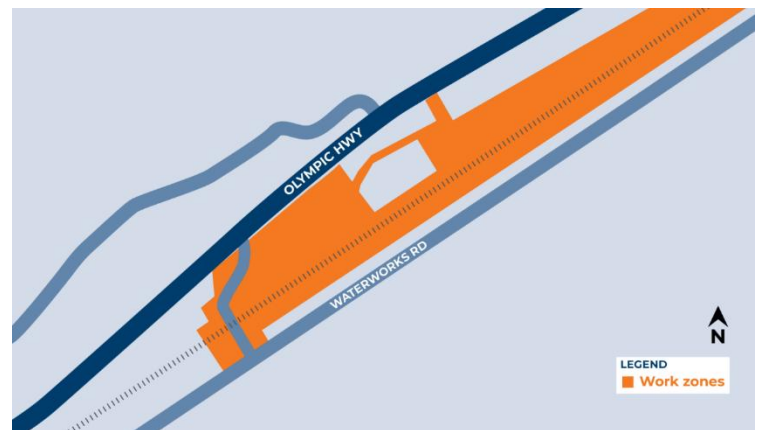

Please scan the QR code for latest information.

☎ 1800 732 761    @ inlandrailnsw@inlandrail.com.au

✉ GPO Box 14, Sydney NSW 2000

🗣 Please call our free translation and interpreter service on 131 450 (24 hours a day) if English is your second language and you need help reading this document